

**1** Remove frame and graphic from nylon bag.

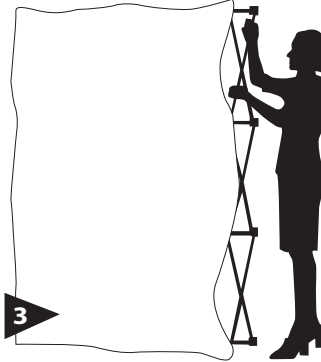

**2** Ensure "adjustable feet" of frame are on the floor. Pull up display into upright position.



**3** Lock all hooks between front and back hubs.



**4** Adjust leveling feet for desired angle. OneFabric display can now easily be moved into position.

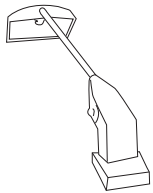

**5** OPTIONAL

Attach lights to top of frame by sliding the light over the channel on top of the frame.

**Warning:** To avoid damage, separate end caps & disconnect ALL hooks before collapsing the frame.

### How to install or replace graphics on your OneFabric:

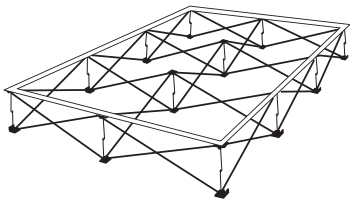

**1** Assemble frame and lay flat on its back. Remove existing graphic.

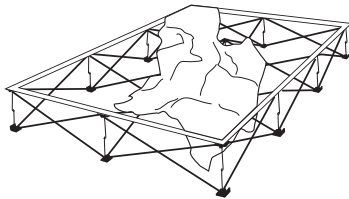

**2** Starting at one corner, attach velcro on the graphic to velcro on the frame. NOTE: Velcro on the graphic should extend approx. 1/4" - 1/2" beyond velcro on the frame (it should not be flush).

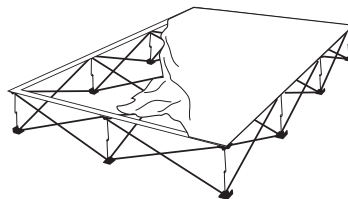

**3** Working in a continuous direction around the frame, attach the rest of the graphic. Make sure the graphic is pulled taut while attaching the velcro.

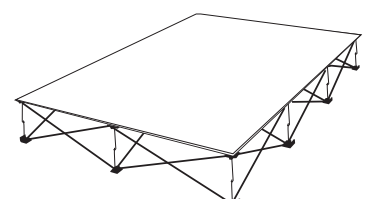

**4** If needed, adjust velcro for taut fit.